

First handling:

The entire delivered ITkPix Tool v1.0 was cleaned before mounting and has to be used in a strict clean and sensitive way.

But before using, it has to be cleaned again at specific areas and parts (shown below). Also, each additional part which touches some of the specific areas like the Baremodule, Flex or its Dummys has to be cleaned in beforehand. At first, there must not be any grime as well as subsequently no lint. The tool should ideally use in a clean room or at least under a flow bench.

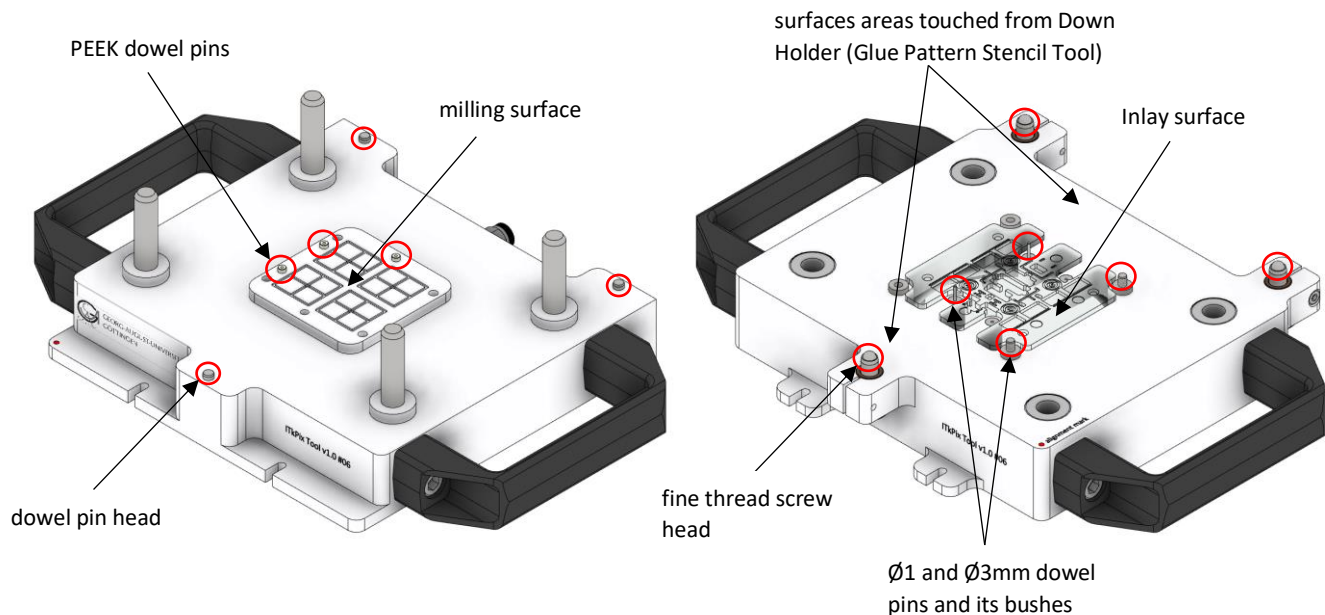

Also, additional parts of the Glue Pattern Stencil Tool, the entire Glue Distributor, entire Glue Pattern Sheet, the Down Holder (Bars) and the surfaces between Down Holder and Glue Pattern Sheet has to be cleaned free of any grime and lint before using and cleaned of glue after using, especially inside of the holes where the glue will collect.

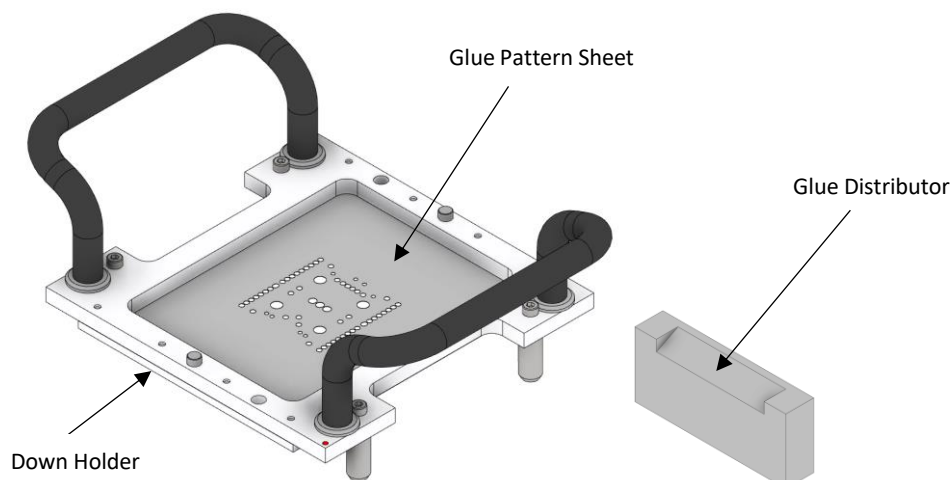

One of the most sensitive areas are the touching surfaces for the Baremodule and Flex because they are made of delicate material. In the delivered state is a lint-free cloth between the joined jigs (Baremodule- and Flex Jig). This cloth has to be between the surfaces when the both jigs not used but joined to each other.

Also, one of the most sensitive parts are the Gauge Sheets, these are delivered in an additional little box. Take care of its instability due to its thickness, it should not get any bending. To handle these instable parts, they have projections on the sides to take it smoothly by a tweezer or alternative take it in the middle of the part by a smooth vacuum gripper.

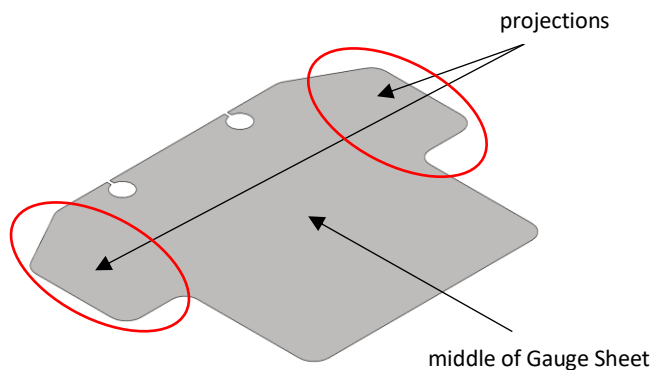

This description is only a first rough overview of how to use the tool to avoid wrong handling, a detailed description about the gluing process by the tool will follow.