

A-A ( 5 : 1 )

hardened and tempered  
50+10 HRC

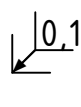

workpiece edges  
DIN ISO 13715

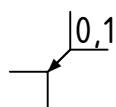
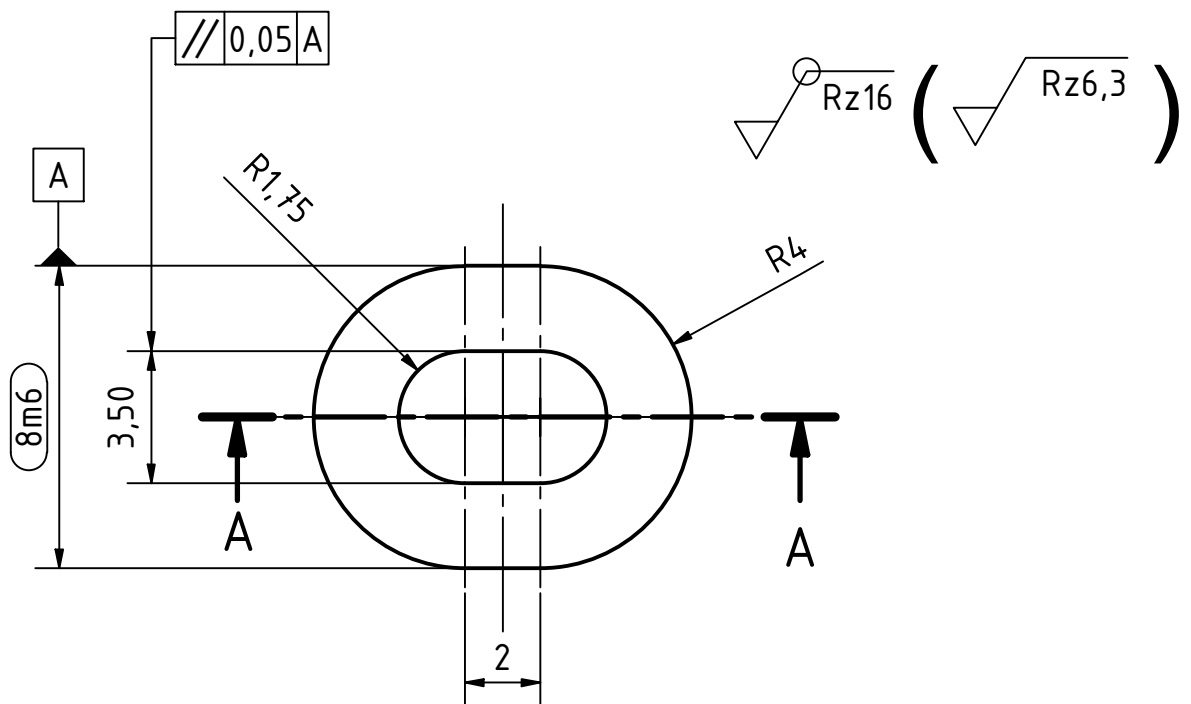
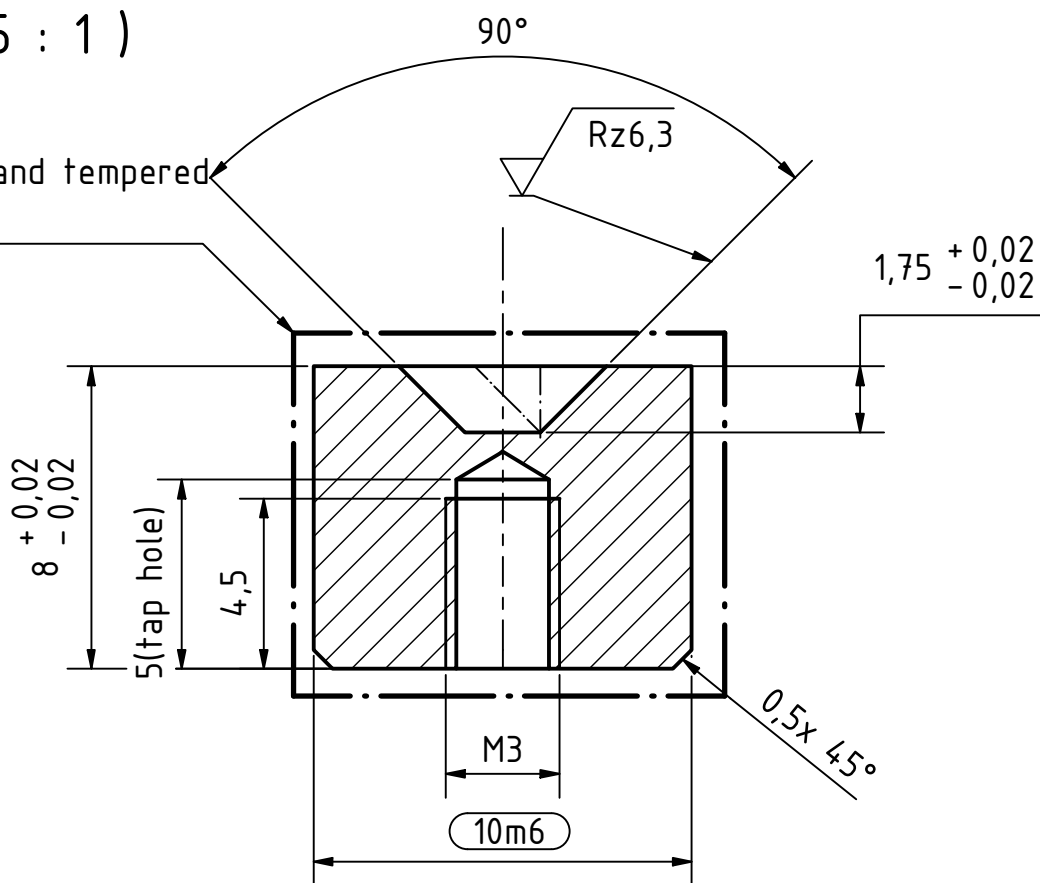

general tolerances  
DIN ISO 2768-m  
surfaces  
DIN ISO 1302

amount: 1

scale: 5 : 1

material: 1.2210 (115CrV3)

pre-product:

designation: Plate Slot 90° Inlay

part number: ITPTv2.01.00.12

field of application: ITkPixTool v2.0

project: Atlas ITk Pixel Module

date	name
designed: 13.07.2021	Rüdiger Widera
approved:	
status:	released
part rev.: 1.0	draw rev.: A



GEORG-AUGUST-UNIVERSITÄT  
GÖTTINGEN

2.Physikalisches Institut  
Friedrich-Hund-Platz 1  
D-37077 Göttingen

Tel.: 0551 3927625  
tim.kanngiesser@uni-goettingen.de  
ruediger.widera@uni-goettingen.de

sheet  
1/1  
A4

rev.	alteration	date	name
------	------------	------	------