

A-A ( 5:1 )

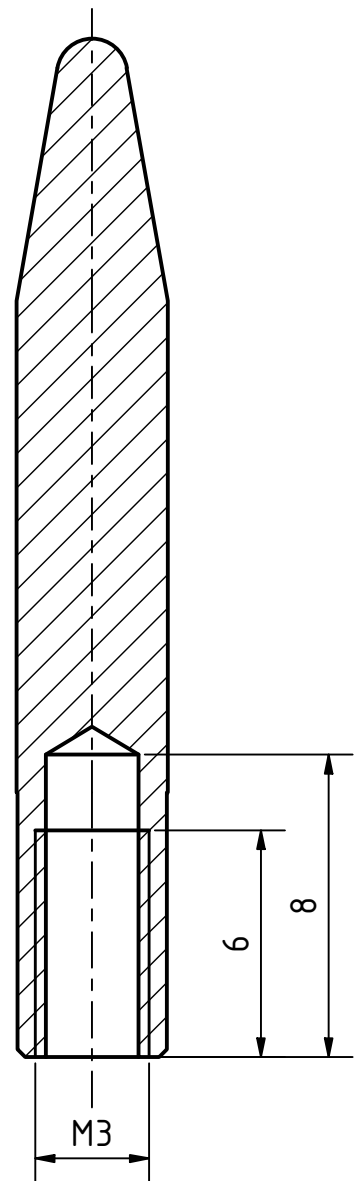

 deburred edges		workpiece edges DIN ISO 13715	general tolerances DIN ISO 2768-f/H surfaces DIN ISO 1302	amount: 1	scale: 5:1
				material: X8CrNiS18-9	pre-product: Round Bar
				designation: Dowel Pin 4mm part number: ITPTv2.01.00.20 field of application: ITkPixTool v2.0 project: Atlas ITk Pixel Modules	
				<div>  GEORG-AUGUST-UNIVERSITÄT GÖTTINGEN </div> <div> 2.Physikalisches Institut Friedrich-Hund-Platz 1 D-37077 Göttingen </div> <div> Tel.: 0551 3927625 tim.kanngiesser@uni-goettingen.de ruediger.widera@uni-goettingen.de </div>	
rev.	alteration	date	name	sheet 1/1 A4	