

fit	allowance
6g6	-4µm -12µm
12g6	-6µm -17µm
82g6	-12µm -34µm

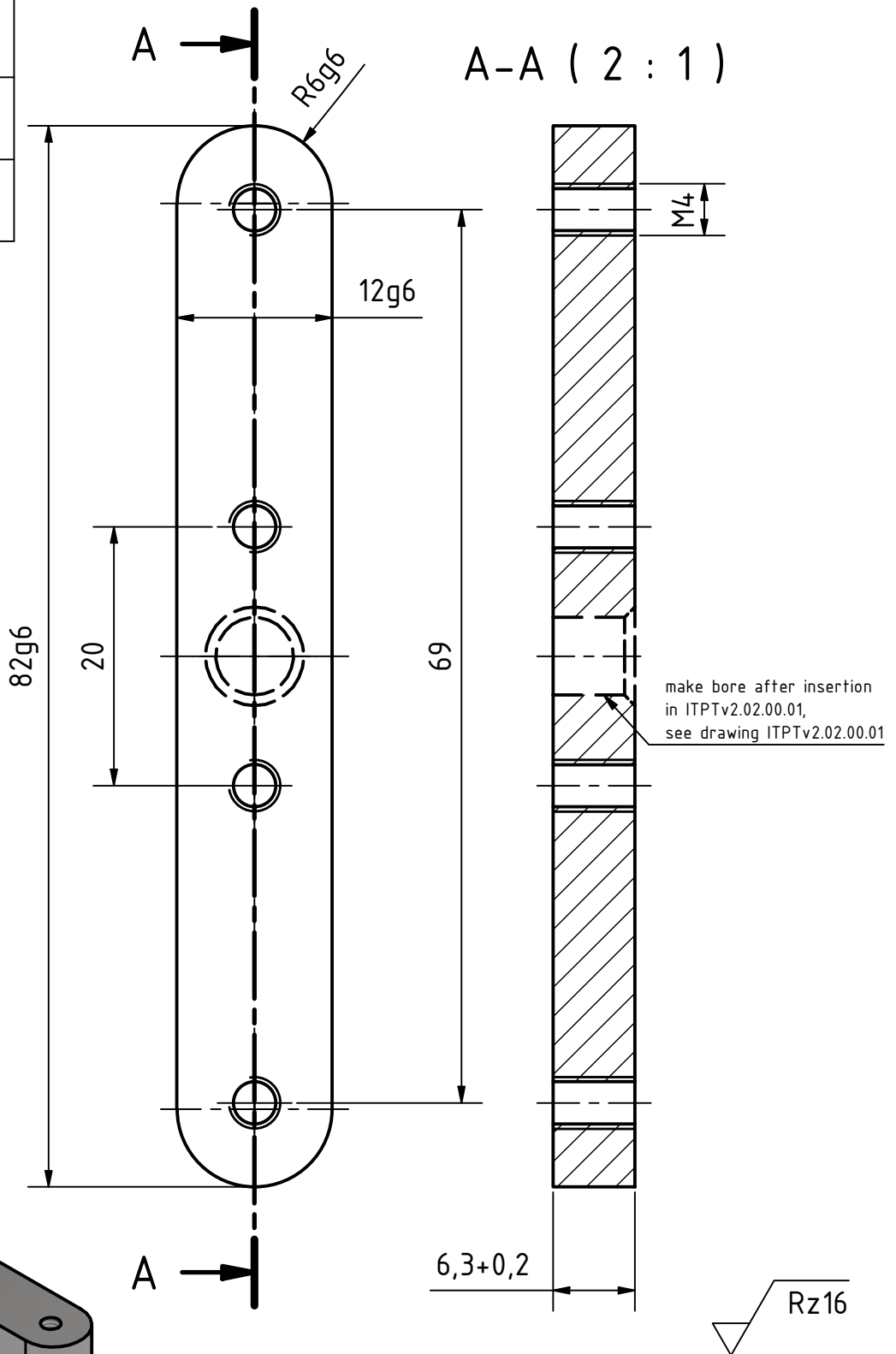

geometric dimensioning
and tolerancing
DIN EN ISO 1101

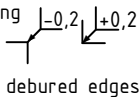

workpiece edges
DIN ISO 13715



general tolerances
DIN ISO 2768-m/ K
surfaces
DIN ISO 1302

amount: 1

scale: 2 : 1

material: 1.4305

pre-product: -

rev.	alteration	date	name

date	name
designed: 11.07.2022	Tim Kanngießner
approved: 11.07.2022	R. Widera
status:	released
part rev.: 1.0	draw. rev.: A

designation: Insert Bottom Flex Jig Basebody
part number: ITPTv2.02.00.11
field of application: ITkPixTool v2.0
project: Atlas ITk Pixel Modules



GEORG-AUGUST-UNIVERSITÄT
GÖTTINGEN

2. Physikalisches Institut
Friedrich-Hund-Platz 1
D-37077 Göttingen

Tel.: 0551 3927625
tim.kanngiesser@uni-goettingen.de
ruediger.widera@uni-goettingen.de

sheet
1/1
A4